

D&D MOTOR SYSTEMS INC.			
SYRACUSE N.Y.			
A2	Model # ES-147-13		A1
S2	Mfg. Date	Serial #	Rating
	XXXXXX	XXXX	CLASS H
			Voltage
			XXXX
			MADE IN U.S.A.

**TORQUE SPECIFICATION FOR
POWER CABLE SECURING TOP NUTS**
3/8 - 16 UNC - 140 IN / LBS MAX

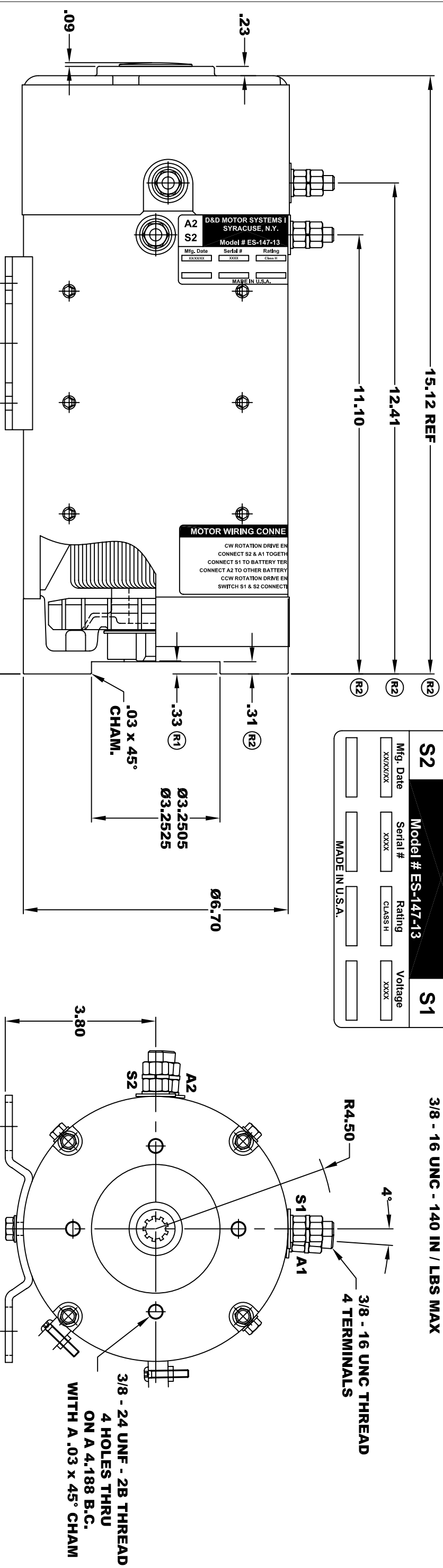

D&D MOTOR SYSTEMS I SYRACUSE, N.Y.			
Model # ES-147-13			
Mfg. Date	Serial #	Rating	Class #
XXXXXX	XXXX		
MADE IN U.S.A.			

MOTOR WIRING CONNE
CW ROTATION DRIVE EN
CONNECT S2 & A1 TOGETHER
CONNECT S1 TO BATTERY TER
CONNECT A2 TO OTHER BATTERY
CCW ROTATION DRIVE EN
SWITCH S1 & S2 CONNECT

SPLINE HARDNESS →
R/C 46 - 52

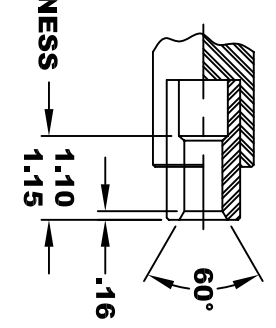

MOTOR WEIGHT: XX LBS
CLASS "H" INSULATION
PERFORMANCE SPEC: 13

INTERNAL INVOLUTE SPLINE SPECIFICATION
FLAT ROOT SIDE FIT (PER A.N.S.I. B92.1 CLASS 5)

NO. OF TEETH _____ 9
SPLINE PITCH _____ 16 / 32
PRESSURE ANGLE _____ 30°
BASE Ø _____ .4871 REF
PITCH Ø _____ .5625 REF
MAJOR Ø _____ .651
FORM Ø _____ .629
MINOR Ø _____ .509 - .514

⊙	.010	A
⊕	.010	B

ELECTRICAL WIRING DIAGRAM

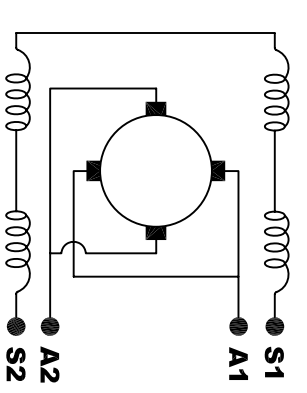

MOTOR WIRING CONNECTIONS:
CW ROTATION DRIVE END
CONNECT S2 & A1 TOGETHER
CONNECT S1 TO BATTERY TERMINAL
CONNECT A2 TO OTHER BATTERY TERMINAL
CCW ROTATION DRIVE END
SWITCH S1 & S2 CONNECTIONS

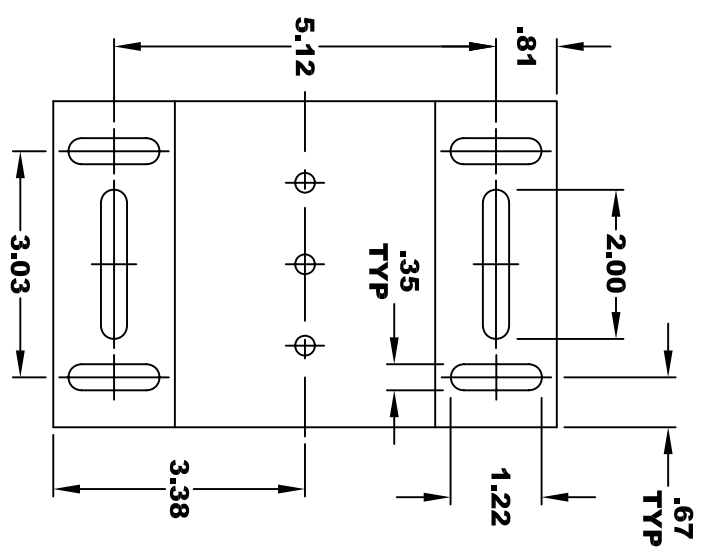

CIRCULAR SPACE WIDTH
MAX ACTUAL _____ .1008
MIN EFFECTIVE _____ .0982
MAX DIMENSION BETWEEN
TWO PINS _____ .3972
PIN Ø _____ .1080

THIS PRINT IS THE PROPERTY OF D&D MOTOR SYSTEMS INC.
DO NOT SCALE
WORK TO DIMENSIONS
TOLERANCES UNLESS OTHERWISE SPECIFIED ARE AS FOLLOWS
.XX _____ .01
.XXX _____ .005
.XX ROUGH CASTING _____ .03
HOLES _____ -.001 / +.006
ANGLES _____ 0°30"

D & D MOTOR SYSTEMS INC

MOTOR OUTLINE

SIZE	DRAWN DATE	RELEASE DATE	DWG NO. / PART NO.	REV
B	12-28-09		ES-147-13	R2
SCALE	STF	DRAWN BY	MJG	REV DATE
				2-17-16