

R1 REVISED VIEW

D&D MOTOR SYSTEMS INC.			
SYRACUSE N.Y.			
A2	S2	A1	S1
Model # ES-31D			
Mfg. Date	Serial #	Rating	Voltage
XXXXXX	XXXX	Class H	48 / 72
MADE IN U.S.A.			

**TORQUE SPECIFICATION FOR
POWER CABLE SECURING TOP NUTS**
3/8-16 UNC - 140 IN / LBS MAX

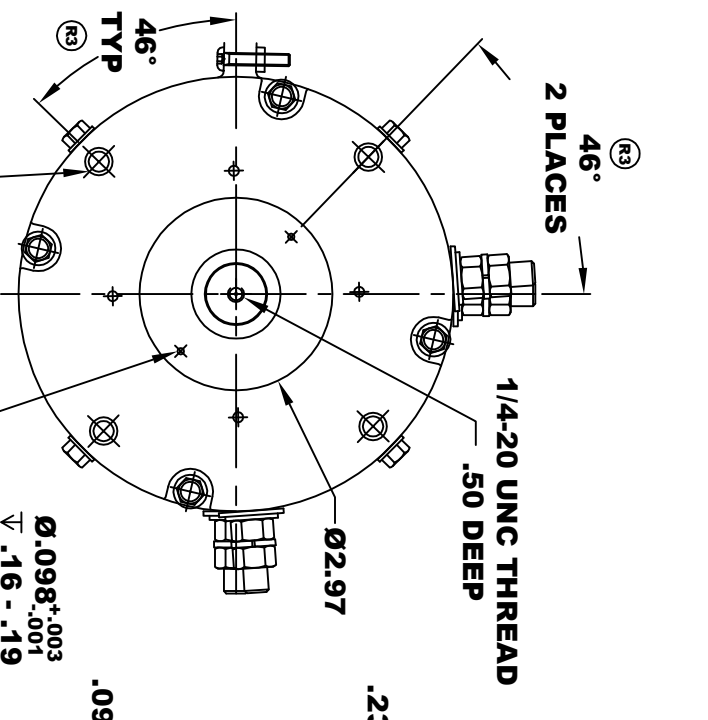

Ø2.97
Ø.098±.003
▽.16-.19
2 HOLES
EQUALLY SPACED
ON A 2.45 B.C.
Ø 3/8 - 16 UNC THREAD
TAPPED THRU
.03-.05 x 45° CHAMFER
4 PLACES, ON A Ø5.875 B. C.
46° TYP
R3

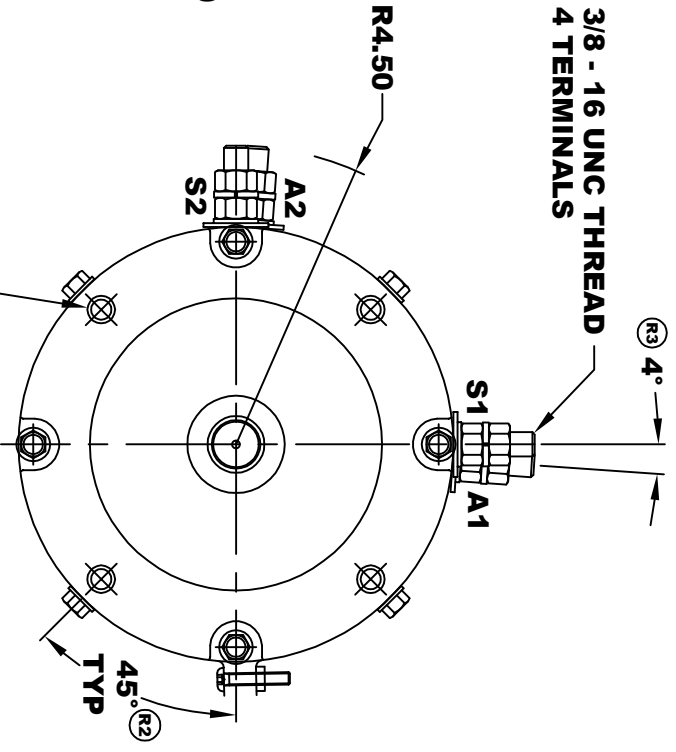
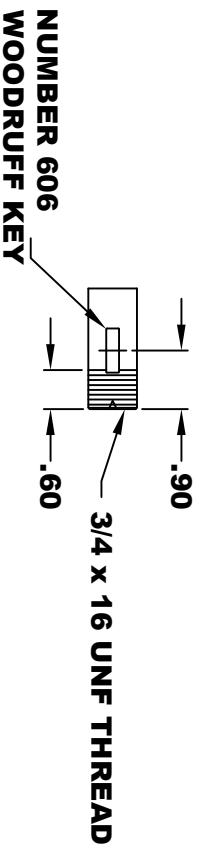
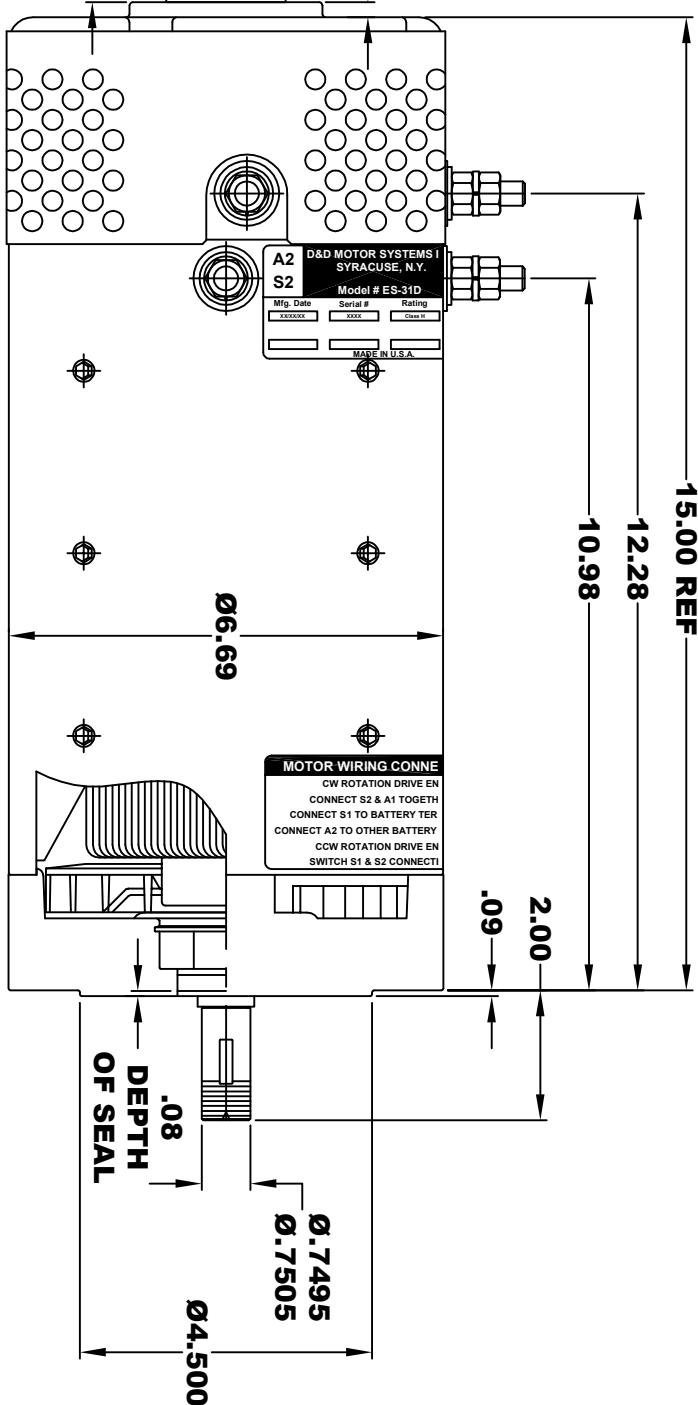

Ø4.500
R4.50
3/8 - 16 UNC THREAD
4 PLACES, ON A Ø5.875 B. C.
Ø.03 - .05 x 45° CHAMFER
▽.65 MINIMUM
45° TYP
R2

MOTOR WEIGHT: 83 LBS
CLASS "H" INSULATION
PERFORMANCE SPEC: 53

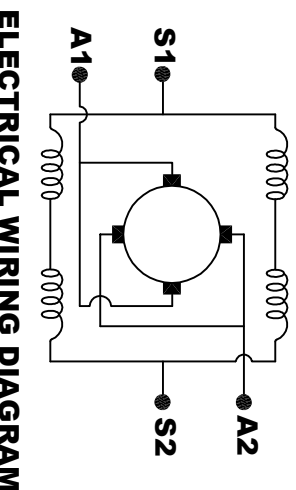

ELECTRICAL WIRING DIAGRAM

MOTOR WIRING CONNECTIONS:
CW ROTATION DRIVE END
CONNECT S2 & A1 TOGETHER
CONNECT S1 TO BATTERY TERMINAL
CCW ROTATION DRIVE END
CONNECT A2 TO OTHER BATTERY TERMINAL
CONNECT S1 & S2 TO OTHER BATTERY TERMINAL
SWITCH S1 & S2 CONNECTIONS

THIS PRINT IS THE PROPERTY OF D&D MOTOR SYSTEMS INC.
DO NOT SCALE
WORK TO DIMENSIONS
TOLERANCES UNLESS OTHERWISE SPECIFIED ARE AS FOLLOWS
.XX _____ .01
.XXX _____ .005
.XX ROUGH CASTING _____ .03
HOLES _____ .001 / +.006
ANGLES _____ 0°30"

D & D MOTOR SYSTEMS INC			
MOTOR OUTLINE			
SIZE	DRAWN DATE	RELEASE DATE	DWG NO. / PART NO.
B	7-1-04		ES-31D
SCALE	STF	DRAWN BY	MJG
			REV DATE
			R3 5-18-20