

D&D MOTOR SYSTEMS INC.			
A2	S2	S1	A1
SYRACUSE N.Y.			
Model #	ES-67C-29	Rating	CLASS H
Serial #	XXXX	Voltage	XX
Mfg. Date	XXXXXX	MADE IN U.S.A.	

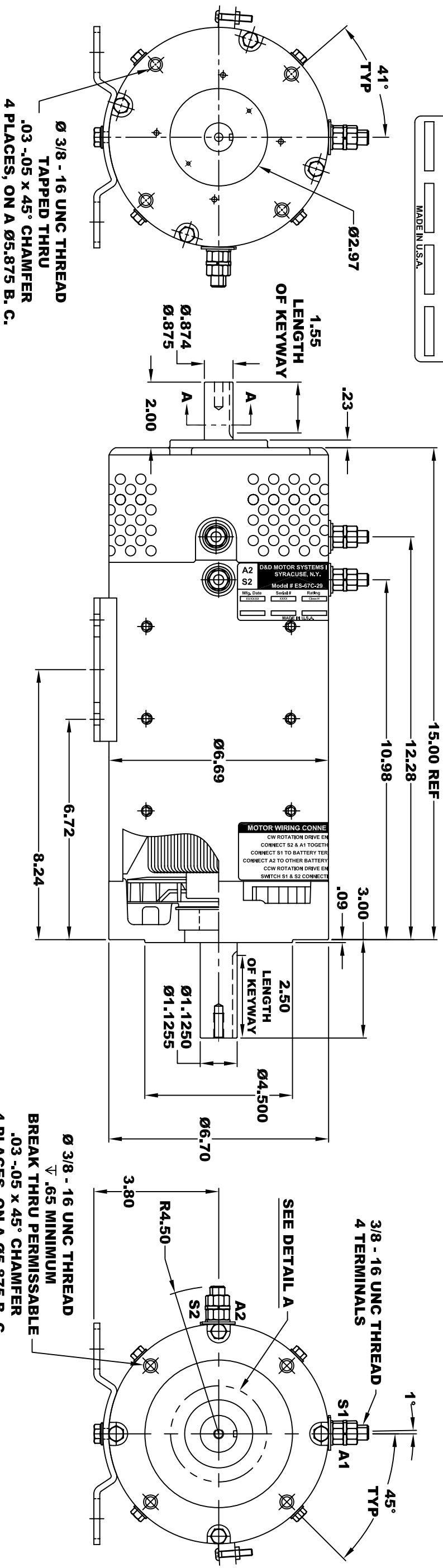

**TORQUE SPECIFICATION FOR
POWER CABLE SECURING TOP NUTS**
3/8-16 UNC - 140 IN / LBS MAX

**Ø 3/8 - 16 UNC THREAD
↓ .65 MINIMUM
BREAK THRU PERMISSIBLE
.03 -.05 x 45° CHAMFER
4 PLACES, ON A Ø5.875 B. C.**

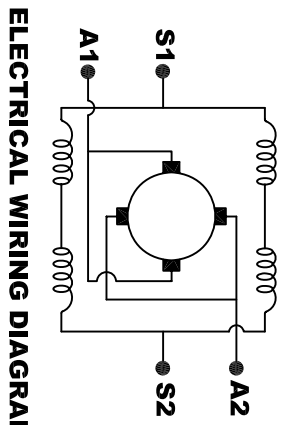

MOTOR WIRING CONNECTIONS:
CW ROTATION DRIVE END
CONNECT S2 & A1 TOGETHER
CONNECT S1 TO BATTERY TERMINAL
CONNECT A2 TO OTHER BATTERY TERMINAL
CCW ROTATION DRIVE END
SWITCH S1 & S2 CONNECTIONS

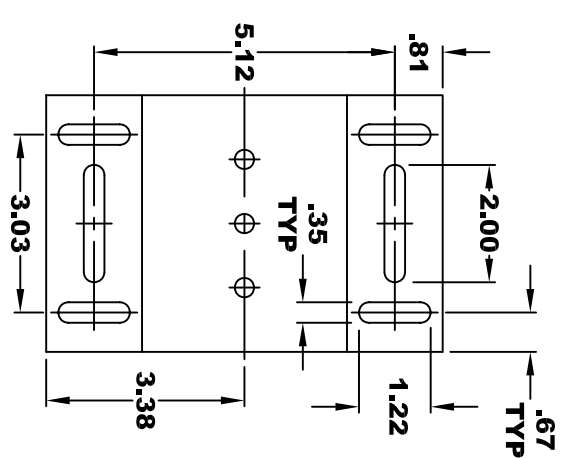

**5/16 - 18 UNC THREAD
↓ .75**

**5/16 - 18 UNC THREAD
↓ .75**

SECTION A - A

DETAIL A

MOTOR WEIGHT: 83 LBS
CLASS "H" INSULATION
PERFORMANCE SPEC: 29

THIS PRINT IS THE PROPERTY OF D&D MOTOR SYSTEMS INC.
DO NOT SCALE
WORK TO DIMENSIONS
TOLERANCES UNLESS OTHERWISE SPECIFIED ARE AS FOLLOWS
.XX _____ .01
.XXX _____ .005
.XX ROUGH CASTING _____ .03
HOLES _____ -.001 / +.006
ANGLES _____ 0°30"

D & D MOTOR SYSTEMS INC			
MOTOR OUTLINE			
SIZE	DRAWN DATE	RELEASE DATE	DWG NO. / PART NO.
B	2-5-07		ES-67C-29
SCALE	STF	DRAWN BY	MJG
			REV DATE