

D&D MOTOR SYSTEMS INC.
SYRACUSE N.Y.

Model # ES-74

Mfg. Date	Serial #	Rating	Duty
xxxx/xx	xxxx	CLASS -H	S2-60 MIN
Voltage	Current	R.P.M.	H.P.
xx	xxxx	xxxx	xx
MADE IN U.S.A.			

**TORQUE SPECIFICATION FOR
 POWER CABLE SECURING TOP NUTS**
 3/8 - 16 UNC - 140 IN / LBS MAX

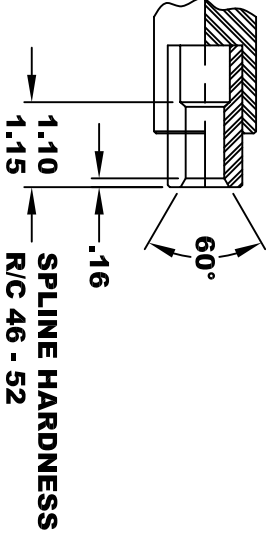
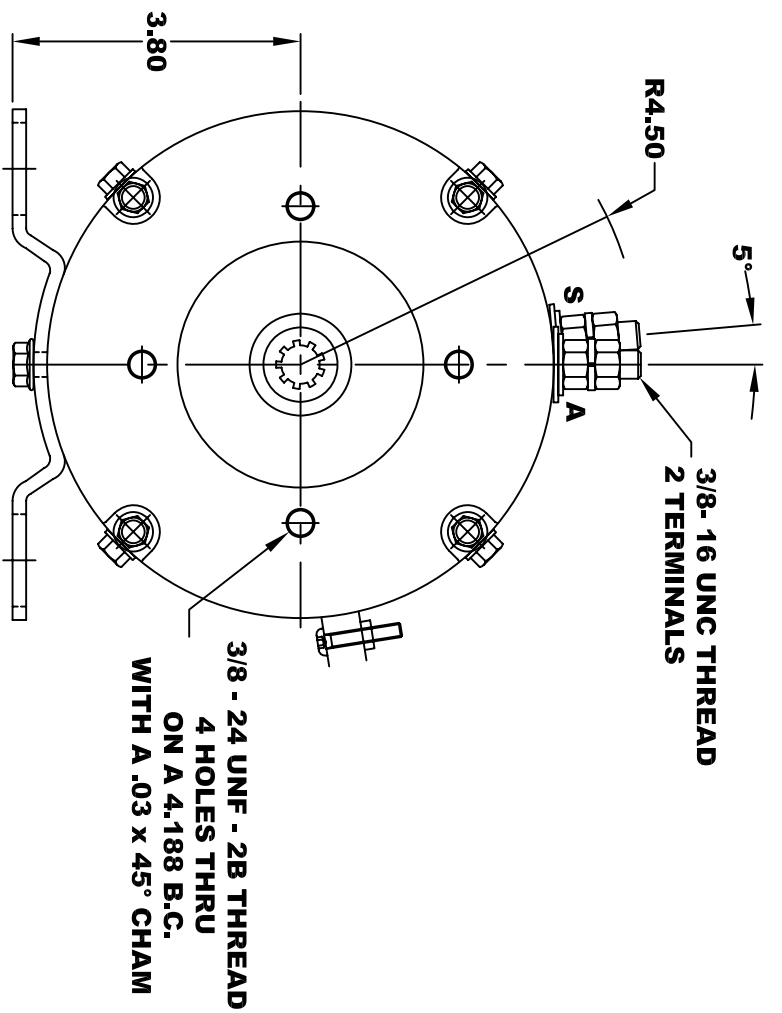
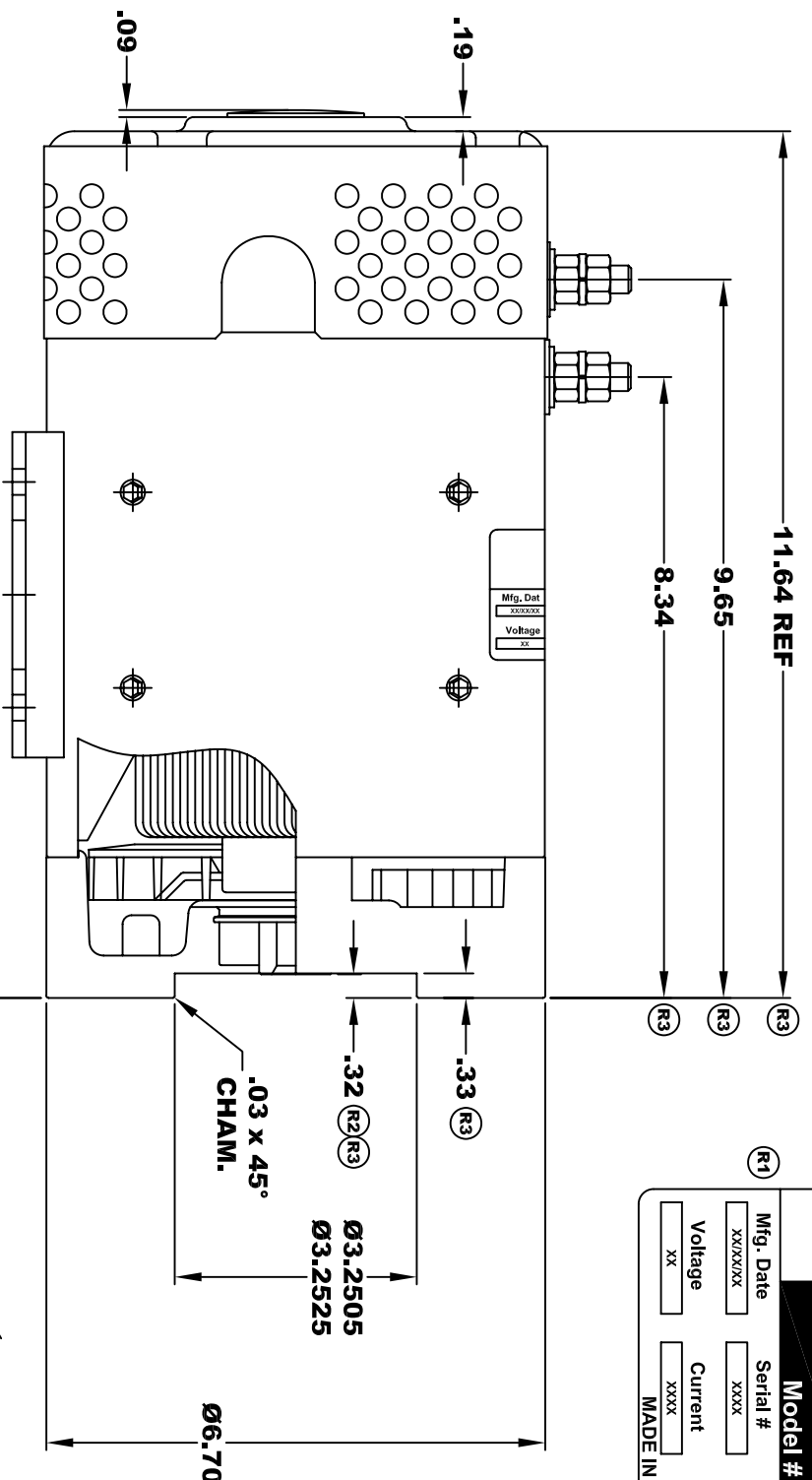

INTERNAL INVOLUTE SPLINE SPECIFICATION
 FLAT ROOT SIDE FIT (PER A.N.S.I. B92.1 CLASS 5)

- NO. OF TEETH _____ 9
- SPLINE PITCH _____ 16 / 32
- PRESSURE ANGLE _____ 30°
- BASE Ø _____ .4871 REF
- PITCH Ø _____ .5625 REF
- MAJOR Ø _____ .651
- FORM Ø _____ .629
- MINOR Ø _____ .509 - .514

⊙	.010	A
L	.010	B

- CIRCULAR SPACE WIDTH
- MAX ACTUAL _____ .1008
- MIN EFFECTIVE _____ .0982
- MAX DIMENSION BETWEEN TWO PINS _____ .3972
- PIN Ø _____ .1080

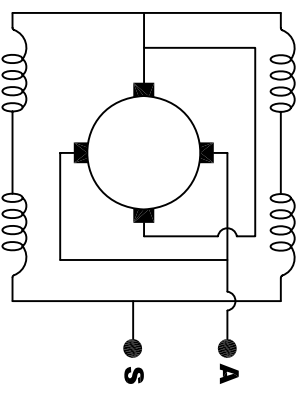

ELECTRICAL WIRING DIAGRAM

MOTOR WEIGHT: 60 LBS
 CLASS "H" INSULATION
 PERFORMANCE SPEC: 41

MOTOR WIRING CONNECTIONS:
 CW ROTATION DRIVE END
 CONNECT ONE POWER CABLE TO TERMINAL A
 CONNECT THE OTHER POWER CABLE TO TERMINAL S

D & D MOTOR SYSTEMS INC

MOTOR OUTLINE

THIS PRINT IS THE PROPERTY OF D&D MOTOR SYSTEMS INC.
 DO NOT SCALE
 WORK TO DIMENSIONS
 TOLERANCES UNLESS OTHERWISE SPECIFIED ARE AS FOLLOWS
 .XX _____ .01
 .XXX _____ .005
 .XX ROUGH CASTING _____ .03
 HOLES _____ -.001 / +.006
 ANGLES _____ 0°30"

SIZE	DRAWN DATE	RELEASE DATE	DWG NO. / PART NO.	REV
B	3-27-03		ES-74	R3
SCALE	STF	DRAWN BY	MJG	REV DATE
				2-18-16