

D&D MOTOR SYSTEMS INC. SYRACUSE N.Y.			
A2	Model # ES-99-16		A1
S2	Serial #	Rating	S1
Mfg. Date	xxxx	CLASS-H	Voltage
xxxxxx			xx
MADE IN U.S.A.			

**TORQUE SPECIFICATION FOR
POWER CABLE SECURING TOP NUTS**
3/8-16 UNC - 140 IN / LBS MAX

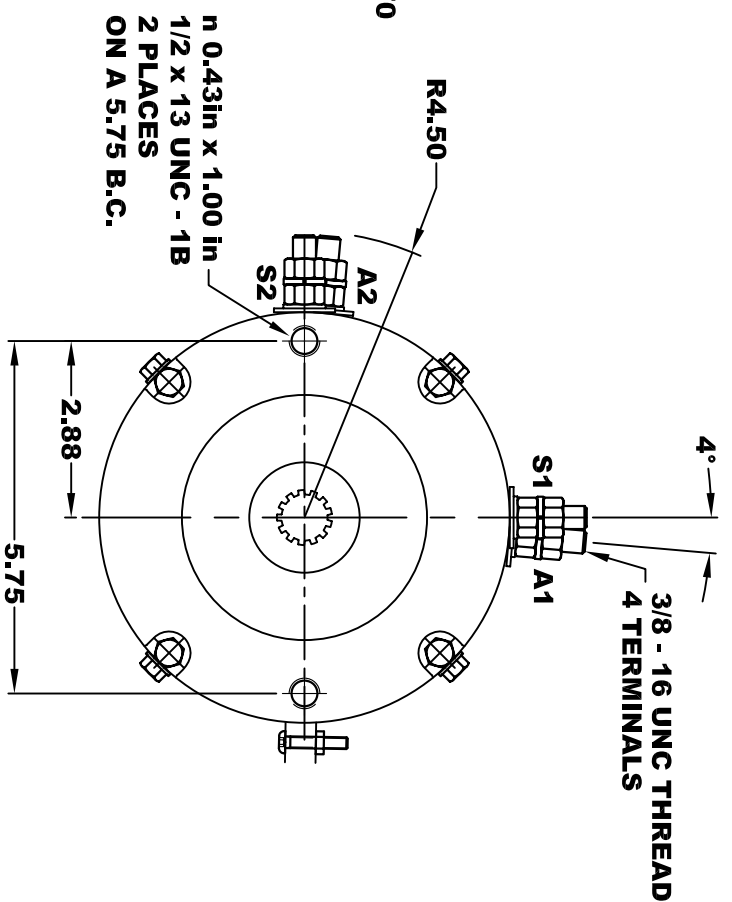
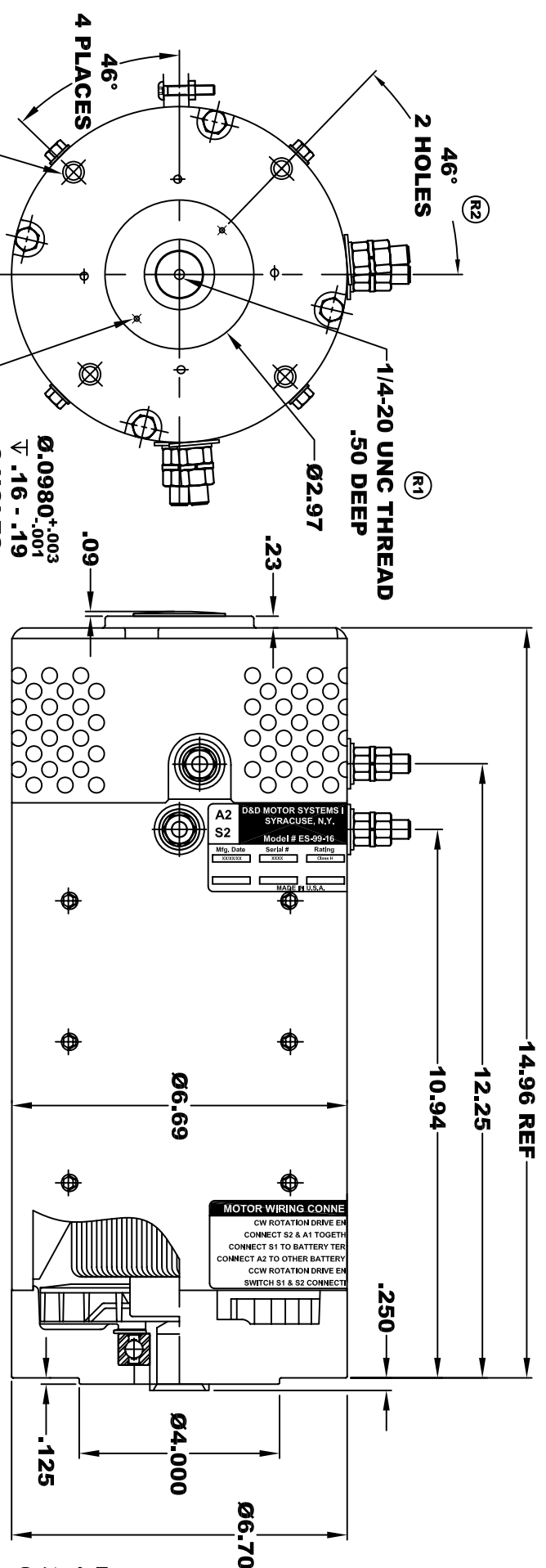

Ø 3/8 - 16 UNC THREAD
TAPPED THRU
.03-.05 x 45° CHAMFER
4 PLACES, ON A Ø5.875 B. C.

INTERNAL INVOLUTE SPLINE SPECIFICATION
FILLET ROOT SIDE FIT (PER A.N.S.I. B92.1 CLASS 5)

NO. OF TEETH _____ 13
SPLINE PITCH _____ 16 / 32
PRESSURE ANGLE _____ 30°
BASE Ø _____ .7036 REF
PITCH Ø _____ .8125 REF
MAJOR Ø _____ .901
FORM Ø _____ .879
MINOR Ø _____ .754

⊙	.010	A
⊥	.010	B

CIRCULAR SPACE WIDTH _____
MAX ACTUAL _____ .1008
MIN EFFECTIVE _____ .XXXX
MAX DIMENSION BETWEEN
TWO PINS _____ .XXXX
PIN Ø _____ .XXXX

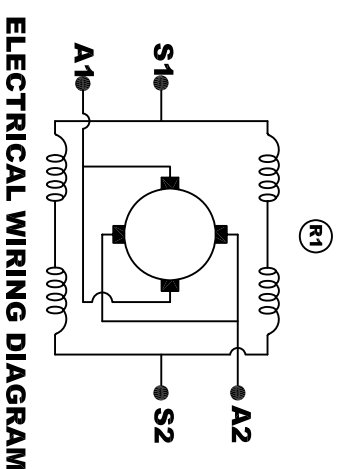
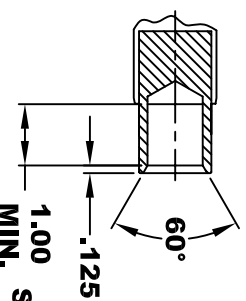

MOTOR WIRING CONNECTIONS:
CW ROTATION DRIVE END
CONNECT S2 & A1 TOGETHER
CONNECT S1 TO BATTERY TERMINAL
CONNECT A2 TO OTHER BATTERY TERMINAL
CCW ROTATION DRIVE END
SWITCH S1 & S2 CONNECTIONS

MOTOR WEIGHT: 83 LBS
CLASS "H" INSULATION
Ⓡ1 PERFORMANCE SPEC: 16

D & D MOTOR SYSTEMS INC

MOTOR OUTLINE

THIS PRINT IS THE PROPERTY OF D&D MOTOR SYSTEMS INC.
DO NOT SCALE
WORK TO DIMENSIONS
TOLERANCES UNLESS OTHERWISE SPECIFIED ARE AS FOLLOWS
.XX _____ .01
.XXX _____ .005
.XXX ROUGH CASTING _____ .03
HOLES _____ -.001 / +.006
ANGLES _____ 0°30"

SIZE	DRAWN DATE	RELEASE DATE	DWG NO. / PART NO.	REV
B	4-1-04		ES-99-16 Ⓡ1	R2
SCALE	STF	DRAWN BY	MJG	REV DATE
				1-24-06